

Paper Roll Clamps, 360-degree Rotation

Models AMC-P-PS 48-55-60-66

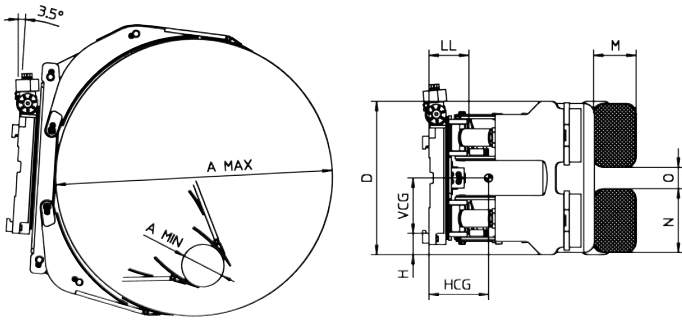

Range: 4,000 - 7,100 Lbs.

- 360-degree rotating paper roll clamp for safe and effective vertical and horizontal paper roll handling.
- Pivoting long arm movement with hydraulically positionable short arm.
- Slim arm design with optimal visibility in clamp.
- Models AMC-P: Non split long arm for single roll handling.
- Models AMC-PS: Split arm for 1-2 roll handling.
- Several contact pad options in standard series.
- Built in pressure relief valves for setting of optimal clamping force.

Model	Capacity Lbs.	Load Center	Roll Range	Height	Weight Lbs.	Horizontal Center of Gravity	Vertical Center of Gravity	Effective Thickness	Minimum Carriage Width	Contact Pads	Contact Pad Gap	Mounting Height	Mounting Class
	Q	BP	A	D	W	HCG	VCG	LL	FL	M x N	O	H	
Single roll clamps - Unsplit long arm													
AMC-48-1051-P	4,800	25.5"	10"-51"	32.3"	1,570	10.8"	16.6"	7.9"	39.4"	8.7" x 11.8"	-	5.9"	II/III
AMC-48-1060-P	4,000	30.0"	10"-60"	32.3"	1,640	11.9"	16.6"	7.9"	39.4"	8.7" x 11.8"	-	5.9"	II/III
AMC-48-1063-P	4,000	31.5"	10"-63"	32.3"	1,700	12.2"	16.6"	7.9"	39.4"	8.7" x 11.8"	-	5.9"	II/III
1 - 2 roll clamps - Split long arm													
AMC-48-1051-PS	4,800	25.5"	10"-51"	32.3"	1,550	10.5"	16.6"	7.9"	39.4"	8.7" x 11.8"	7.9"	5.9"	II/III
AMC-48-1060-PS	4,000	29.9"	10"-60"	32.3"	1,610	11.6"	16.6"	7.9"	39.4"	8.7" x 11.8"	7.9"	5.9"	II/III
AMC-48-1063-PS	4,000	31.5"	10"-63"	32.3"	1,680	11.9"	16.6"	7.9"	39.4"	8.7" x 11.8"	7.9"	5.9"	II/III
Single roll clamps - Unsplit long arm													
AMC-55-1051-P	5,500	25.5"	10"-51"	40.2"	1,680	10.9"	20.6"	7.9"	39.4"	9.4"x15.7"	-	8.7"	II/III
AMC-55-1060-P	4,600	29.9"	10"-60"	40.2"	1,810	12.0"	20.6"	7.9"	39.4"	9.4"x15.7"	-	8.7"	II/III
AMC-55-1063-P	4,500	31.5"	10"-63"	40.2"	1,830	12.4"	20.6"	7.9"	39.4"	9.4"x15.7"	-	8.7"	II/III
1 - 2 roll clamps - Split long arm													
AMC-55-1051-PS	5,500	25.5"	10"-51"	40.2"	1,660	10.6"	20.6"	7.9"	39.4"	9.4"x15.7"	7.9"	8.7"	II/III
AMC-55-1060-PS	4,600	29.9"	10"-60"	40.2"	1,790	11.6"	20.6"	7.9"	39.4"	9.4"x15.7"	7.9"	8.7"	II/III
AMC-55-1063-PS	4,500	31.5"	10"-63"	40.2"	1,810	12.0"	20.6"	7.9"	39.4"	9.4"x15.7"	7.9"	8.7"	II/III
Single roll clamps - Unsplit long arm													
AMC-60-1051-P	6,200	25.5"	10"-51"	40.2"	1,770	11.4"	20.6"	8.1"	39.4"	9.4" x 15.7"	-	8.7"	III
AMC-60-1060-P	5,200	29.9"	10"-60"	40.2"	1,900	12.4"	20.6"	8.1"	39.4"	9.4" x 15.7"	-	8.7"	III
AMC-60-1063-P	5,100	31.5"	10"-63"	40.2"	1,920	12.8"	20.6"	8.1"	39.4"	9.4" x 15.7"	-	8.7"	III
AMC-60-1072-P	4,200	36.0"	10"-72"	40.2"	2,000	14.2"	20.6"	8.1"	39.4"	9.4" x 15.7"	-	8.7"	III
1 - 2 roll clamps - Split long arm													
AMC-60-1051-PS	6,200	25.5"	10"-51"	40.2"	1,750	11.0"	20.6"	8.1"	39.4"	9.4" x 15.7"	7.9"	8.7"	III
AMC-60-1060-PS	5,200	29.9"	10"-60"	40.2"	1,880	12.0"	20.6"	8.1"	39.4"	9.4" x 15.7"	7.9"	8.7"	III
AMC-60-1063-PS	5,100	31.5"	10"-63"	40.2"	1,900	12.4"	20.6"	8.1"	39.4"	9.4" x 15.7"	7.9"	8.7"	III
AMC-60-1072-PS	4,200	36.0"	10"-72"	40.2"	1,980	13.8"	20.6"	8.1"	39.4"	9.4" x 15.7"	7.9"	8.7"	III
Single roll clamps - Unsplit long arm													
AMC-66-1051-P	7,100	25.5"	10"-51"	40.2"	1,830	11.6"	20.6"	8.1"	39.4"	9.4" x 15.7"	-	8.7"	III
AMC-66-1060-P	6,600	29.9"	10"-60"	40.2"	1,900	12.5"	20.6"	8.1"	39.4"	9.4" x 15.7"	-	8.7"	III
AMC-66-1063-P	6,200	31.5"	10"-63"	40.2"	1,910	12.8"	20.6"	8.1"	39.4"	9.4" x 15.7"	-	8.7"	III
AMC-66-1072-P	5,100	36.0"	10"-72"	40.2"	2,000	14.2"	20.6"	8.1"	39.4"	9.4" x 15.7"	-	8.7"	III
1 - 2 roll clamps - Split long arm													
AMC-66-1051-P	7,100	25.5"	10"-51"	40.2"	1,830	11.6"	20.6"	8.1"	39.4"	9.4" x 15.7"	-	8.7"	III
AMC-66-1060-P	6,600	29.9"	10"-60"	40.2"	1,900	12.5"	20.6"	8.1"	39.4"	9.4" x 15.7"	-	8.7"	III
AMC-66-1063-P	6,200	31.5"	10"-63"	40.2"	1,910	12.8"	20.6"	8.1"	39.4"	9.4" x 15.7"	-	8.7"	III
AMC-66-1072-P	5,100	36.0"	10"-72"	40.2"	2,000	14.2"	20.6"	8.1"	39.4"	9.4" x 15.7"	-	8.7"	III

Notes:

- Two hydraulic functions.
- All models with hydraulically positionable short arm.
- Short arm: adjustable at 45° rotation.
- Adjustable pressure relief valve.
- See hydraulic pressure and flow rate recommendations.
- Standard contact pads: metal grain pattern with high-friction surface.
- Minimum 3.5-degree forward tilt on lift mast is required for horizontal handling. For 0-degree tilt special arms are available. Consult Bolzoni Auramo.

Options:

- Special roll ranges.
- Fixed, non-moving, short arm.
- Contact pad options:
 - steel-sprayed
 - rubber faced
 - polyurethane faced
 - other contact pad friction surfaces
 - full length contact pads.

