

# Paper Roll Clamps, 360-degree Rotation

## Models AMC-P-PS 74-84-90-120

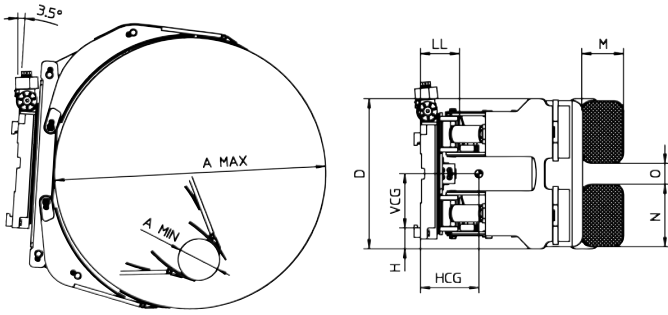

**Range:** 6,200 - 13,200 Lbs.

- 360-degree rotating paper roll clamp for safe and effective vertical and horizontal paper roll handling.
- Pivoting long arm movement with hydraulically positionable short arm.
- Slim arm design with optimal visibility in clamp.
- Models AMC-P: Non split long arm for single roll handling.
- Models AMC-PS: Split arm for 1-2 roll handling.
- Several contact pad options in standard series.
- Built in pressure relief valves for setting of optimal clamping force.

Model	Capacity Lbs.	Load Center	Roll Range	Height	Weight Lbs.	Horizontal Center of Gravity	Vertical Center of Gravity	Effective Thickness	Minimum Carriage Width	Contact Pads	Contact Pad Gap	Mounting Height	Mounting Class
	Q	BP	A	D	W	HCG	VCG	LL	FL	M x N	O	H	
<b>Single roll clamps - Unsplit long arm</b>													
AMC-74-1051-P	7,700	25.5"	10"-51"	40.2"	2,000	11.0"	20.6"	8.5"	45.3"	9.4" x 15.7"	-	7.5"	III/IV
AMC-74-1060-P	7,400	29.9"	10"-60"	40.2"	2,090	12.0"	20.6"	8.5"	45.3"	9.4" x 15.7"	-	7.5"	III/IV
AMC-74-1063-P	7,100	31.5"	10"-63"	40.2"	2,110	12.4"	20.6"	8.5"	45.3"	9.4" x 15.7"	-	7.5"	III/IV
AMC-74-1072-P	6,200	36.0"	10"-72"	40.2"	2,240	13.8"	20.6"	8.5"	45.3"	9.4" x 15.7"	-	7.5"	III/IV
<b>1 - 2 roll clamps - Split long arm</b>													
AMC-74-1051-PS	7,700	25.5"	10"-51"	40.2"	1,970	10.7"	20.6"	8.5"	45.3"	9.4" x 15.7"	7.9"	7.5"	III/IV
AMC-74-1060-PS	7,400	29.9"	10"-60"	40.2"	2,050	11.7"	20.6"	8.5"	45.3"	9.4" x 15.7"	7.9"	7.5"	III/IV
AMC-74-1063-PS	7,100	31.5"	10"-63"	40.2"	2,080	12.1"	20.6"	8.5"	45.3"	9.4" x 15.7"	7.9"	7.5"	III/IV
AMC-74-1072-PS	6,200	36.0"	10"-72"	40.2"	2,210	13.5"	20.6"	8.5"	45.3"	9.4" x 15.7"	7.9"	7.5"	III/IV
<b>Single roll clamps - Unsplit long arm</b>													
AMC-84-1051-P	9,200	25.5"	10"-51"	40.2"	2,310	11.9"	20.6"	8.9"	45.3"	11.0" x 15.7"	-	7.5"	IV
AMC-84-1060-P	8,400	29.9"	10"-60"	40.2"	2,430	12.6"	20.6"	8.9"	45.3"	11.0" x 15.7"	-	7.5"	IV
AMC-84-1063-P	7,700	31.5"	10"-63"	40.2"	2,460	13.0"	20.6"	8.9"	45.3"	11.0" x 15.7"	-	7.5"	IV
AMC-84-1072-P	7,200	36.0"	10"-72"	40.2"	2,560	13.9"	20.6"	8.9"	45.3"	11.0" x 15.7"	-	7.5"	IV
<b>1 - 2 roll clamps - Split long arm</b>													
AMC-84-1051-PS	9,200	25.5"	10"-51"	40.2"	2,280	11.7"	20.6"	8.9"	45.3"	11.0" x 15.7"	7.9"	7.5"	IV
AMC-84-1060-PS	8,400	29.9"	10"-60"	40.2"	2,390	12.4"	20.6"	8.9"	45.3"	11.0" x 15.7"	7.9"	7.5"	IV
AMC-84-1063-PS	7,700	31.5"	10"-63"	40.2"	2,430	12.8"	20.6"	8.9"	45.3"	11.0" x 15.7"	7.9"	7.5"	IV
AMC-84-1072-PS	7,200	36.0"	10"-72"	40.2"	2,524	13.6"	20.6"	8.9"	45.3"	11.0" x 15.7"	7.9"	7.5"	IV
<b>Single roll clamps - Unsplit long arm</b>													
AMC-90-1051-P	10,300	25.5"	10"-51"	40.2"	2,620	15.0"	24.5"	9.4"	41.3"	11.0" x 15.7"	-	6.6"	IV
AMC-90-1060-P	9,000	29.9"	10"-60"	40.2"	2,690	15.9"	24.5"	9.4"	41.3"	11.0" x 15.7"	-	6.6"	IV
AMC-90-1063-P	9,000	31.5"	10"-63"	40.2"	2,710	16.3"	24.5"	9.4"	41.3"	11.0" x 15.7"	-	6.6"	IV
AMC-90-1072-P	7,700	36.0"	10"-72"	40.2"	2,850	17.3"	24.5"	9.4"	41.3"	11.0" x 15.7"	-	6.6"	IV
<b>1 - 2 roll clamps - Split long arm</b>													
AMC-90-1051-PS	10,300	25.5"	10"-51"	40.2"	2,600	14.9"	24.5"	9.4"	41.3"	11.0" x 15.7"	7.9"	6.6"	IV
AMC-90-1060-PS	9,000	29.9"	10"-60"	40.2"	2,670	15.8"	24.5"	9.4"	41.3"	11.0" x 15.7"	7.9"	6.6"	IV
AMC-90-1063-PS	9,000	31.5"	10"-63"	40.2"	2,690	16.2"	24.5"	9.4"	41.3"	11.0" x 15.7"	7.9"	6.6"	IV
AMC-90-1072-PS	7,700	36.0"	10"-72"	40.2"	2,830	17.2"	24.5"	9.4"	41.3"	11.0" x 15.7"	7.9"	6.6"	IV
<b>Single roll clamps - Unsplit long arm</b>													
AMC-120-1851-P	13,200	25.6"	18"-51"	48.0"	3,060	12.4"	24.5"	9.9"	41.3"	11.0" x 19.7"	-	10.6"	IV
AMC-120-2060-P	12,000	29.9"	20"-60"	48.0"	3,230	13.4"	24.5"	9.9"	41.3"	11.0" x 19.7"	-	10.6"	IV
AMC-120-2472-P	10,300	36.0"	24"-72"	48.0"	3,380	15.0"	24.5"	9.9"	41.3"	11.0" x 19.7"	-	10.6"	IV
<b>1 - 2 roll clamps - Split long arm</b>													
AMC-120-1851-PS	13,200	25.6"	18"-51"	48.0"	3,010	12.2"	24.5"	9.9"	41.3"	11.0" x 19.7"	7.9"	10.6"	IV
AMC-120-2060-PS	12,000	29.9"	20"-60"	48.0"	3,190	13.2"	24.5"	9.9"	41.3"	11.0" x 19.7"	7.9"	10.6"	IV
AMC-120-2472-PS	10,300	36.0"	24"-72"	48.0"	3,330	14.8"	24.5"	9.9"	41.3"	11.0" x 19.7"	7.9"	10.6"	IV

### Notes:

- Two hydraulic functions.
- All models with hydraulically positionable short arm.
- Short arm: adjustable at 45° rotation.
- Adjustable pressure relief valve.
- See hydraulic pressure and flow rate recommendations.
- Standard contact pads: metal grain pattern with high-friction surface.
- Minimum 3.5-degree forward tilt on lift mast is required for horizontal handling. For 0-degree tilt special arms are available. Consult Bolzoni Auramo.

### Options:

- Special roll ranges.
- Fixed, non-moving, short arm.
- Contact pad options:
  - steel-sprayed
  - rubber faced
  - polyurethane faced
  - other contact pad friction surfaces
  - full length contact pads.

