

Multi Pallet Handler

Shaft Guide Concept



THE SHAFT GUIDE CONCEPT

THE HIGH PERFORMANCE GUIDE CONCEPT

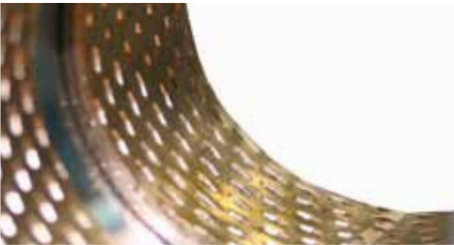

The encapsulated Shaft Guide Concept ...

- **Precisions machined, hard-chromed shafts** in combination with **encapsulated high-performance bushings** (The only encapsulated guide system on the market)

... and its influences on the application performance, life-cycle costs and the environment:

- **Long life of the wearing components**
- **Optimum smooth running and operation speed**
- **High energy efficiency** for extended operation cycles of electric forklift trucks
- **Highly synchronised fork travel**
- **Robust Shaft Guide Concept:** no sagging of the outer forks, permanently safe transport
- **No grease emersion, low grease requirement**
- **Clean load – clean environment**

AUTOMATED LUBRICATION SYSTEM

INTERNATIONAL PATENT

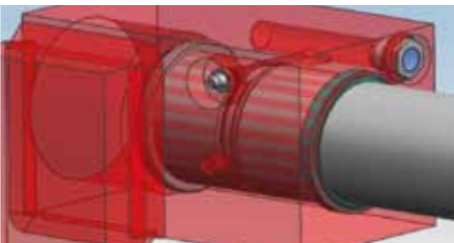

Automated Lubrication ensures **synchronized truck and attachment maintenance intervals** – no intermediate maintenance

Exact adjustment to application conditions and easy re-filling – **Avoids damages or wear caused by no or wrong greasing**, clean operation, no contamination on goods

Automated Lubrication System available as a complete solution or for Shaft Guide System and sideshift separately **Easy and individual retro-fitting possible (on request)**

The Automated Lubrication System is an integral part of the encapsulated MEYER Shaft Guide Concept (Patent) **Reduced maintenance requirements and life cycle costs**

HIGHEST OPERATION SPEED

EFFICIENT LOGISTICS

Influencing factor 'Working Speed':

- Fast speed of operation already at low oil flow (e.g. with minimum execution of a joystick control)
- Improved driver comfort
- Higher through-put

The MEYER shaft-guided pallet handler achieves an up to 50% higher movement speed in operation.

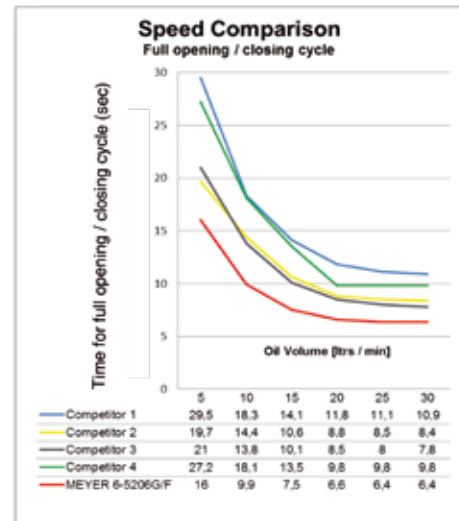

OPTIMUM EQUAL FORK TRAVEL

SAFETY AND ERGONOMICS

Effects and risks of un-equal fork travel:

- Uncomfortable handling at lower oil volume level (e.g. with minimum execution of a joystick control)
- Additional working cycles to re-align the fork travel
- Unsave working conditions, additional handling time
- Risk of pallet damage when entering into the fork pockets, particularly with longer forks

The MEYER Shaft Guide Concept offers synchronized fork travel already at a very low oil flow.

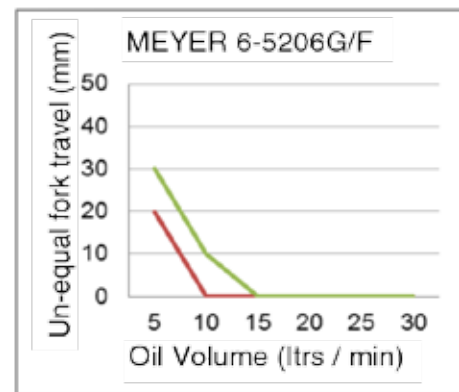

COMPETENCE IN FULL MAINTENANCE ENVIRONMENTS

SUSTAINABILITY AND TOTAL COST OF OWNERSHIP

The MEYER Added-Value Pallet Handler

- 1,000 working hours greasing interval
- More than 2,500 working hours with Autolubrication System
- Lowest maintenance requirements
- Clean operation – clean goods
- Highest energy efficiency
- Ergonomically designed, entirely sustainable
- Fast operating speed, safe operation

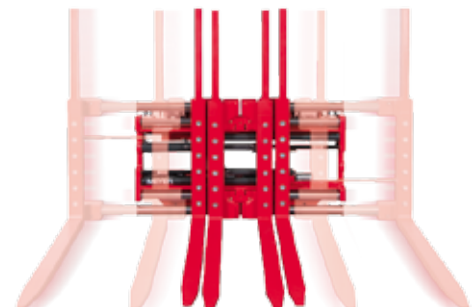

MEYER GmbH

Gittertor 14
38259 Salzgitter
Germany

Tel. +49 5341 803-0
Fax +49 5341 803-196
www.meyer-world.com

Mühlenstr. 74
41352 Korschenbroich
Germany

Tel. +49 2161 999 36-0
Fax +49 2161 999 36-99
www.bolzonigroup.com

MEYER
Since 1950 **MADE IN GERMANY**

BOLZONI
AURAMO 

Lift Truck Attachments · Forks · Lift Tables